

Parts List

Part Number	Description	Quantity
150106	Quick Attach Keeton Bracket Assembly	1
160041	Hardware Kit	1

Compatible with WaveVision® sensors or other seedtubes/sensors

1) Row Unit Preparation

- a) Raise the planter and remove the disk scrapers.
- b) Removing gauge wheels and disk openers is not required but will make installation easier.
- c) Check the seed tube guard and seed tube for wear and replace as necessary. It is not required, but removing the seed tube will make installation easier.

2) Quick Attach Firmer Bracket Installation

- a) Insert the two (2) red rubber plugs into the pipe spacers in the spacer bracket assembly as shown in illustration 1.

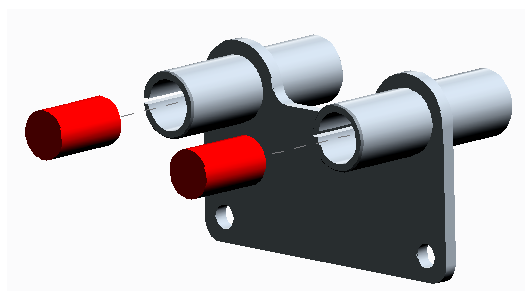

Illustration 1 – Quick Attach Firmer Bracket Assembly

- b) Install the spacer bracket with pre-assembled plugs between the two Keeton bracket pieces. Refer to illustration 2 on the next page.

Contact SI Distributing with Questions: 800-368-7773

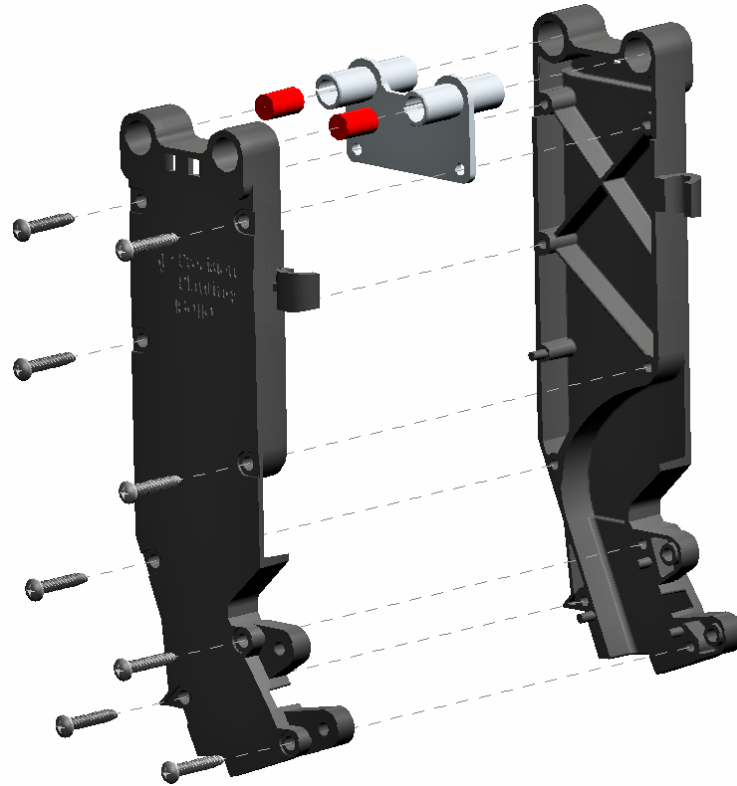

Illustration 2 – Spacer Bracket Installation

- c) Assemble the two bracket pieces with the eight (8) supplied #8 X 1" screws. Refer to illustration 3.



Illustration 3 – Assembled Keeton Firmer Bracket

- d) Slide the bracket into the row unit frame. Align the top holes with the disk scraper mounting holes. Refer to illustration 4.

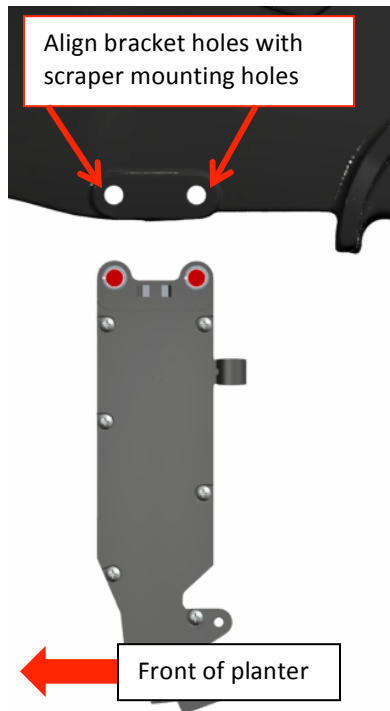

Illustration 4 – Quick Attach Firmer Bracket Aligned with Disk Scraper Mounting Holes

- e) Position the disk scrapers over the mounting holes, then secure the scrapers and the firmer bracket to the row unit with the four (4) supplied 3/8-16 X 1.25" Flange Head Bolts (two each side). Refer to illustration 5.

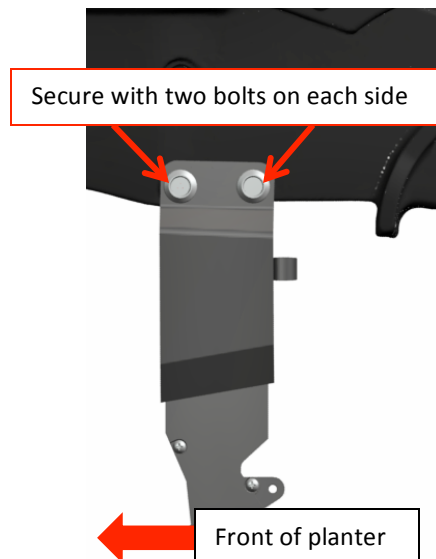

Illustration 5 – Quick Attach Bracket Installed on Row Unit

3) Installation Completion

- a) If the seed tube was removed, reinstall and ensure it is fully seated on the lower seed tube pin.
- b) If the opening disks were removed, reinstall and shim as necessary. **Refer to planter manual for proper shimming and contact of double disk openers.**
- c) If gauge wheels were removed, reinstall according to Manufacturer's instructions.

Setting the Contact between the Disk Openers: To check disk contact, use two pieces of paper and slide one piece in from the top of the disk openers and one from the bottom. Then slide them in toward each other, until they pinch between the disk openers. Measure the distance between the two pieces of paper. If the gap is too wide, you will need to add a shim to the disk opener. If the gap is too narrow you will need to remove a shim. Adjust shims as needed to get the correct contact as stated in the planter manual.

Note: To improve the seed trench “vee”, make sure the opener disks are not worn. If the diameter is less than listed, replace them.

- Kinze 4900 – 14.5”

Correct Contact Between Disk Openers

- 3.0 mm blade thickness – 1.5”–2.5”
- 3.5 mm blade thickness – 1”–1.5”

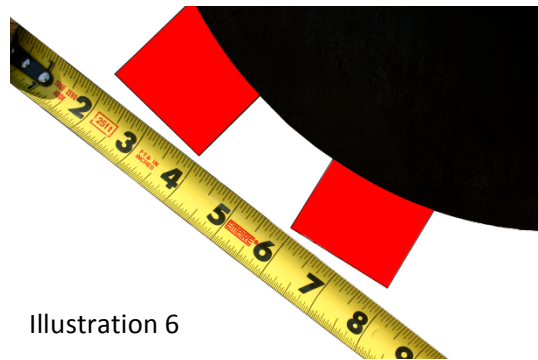

Illustration 6

Contact SI Distributing with Questions: 800-368-7773

Compatible with Quick Attach Brackets KTN150109, KTN150110, and KTN150111

Note: All quick attach tails are capable of applying liquid, if liquid will not be applied through the tail skip to step 2.

1) Liquid Tubing Installation

- a) Locate the ¼" tubing, liquid insert, and splitter (if applicable).

Note: The liquid splitter is pre-installed in the liquid insert. The splitter can be removed if use is not desired. Refer to illustration 1.

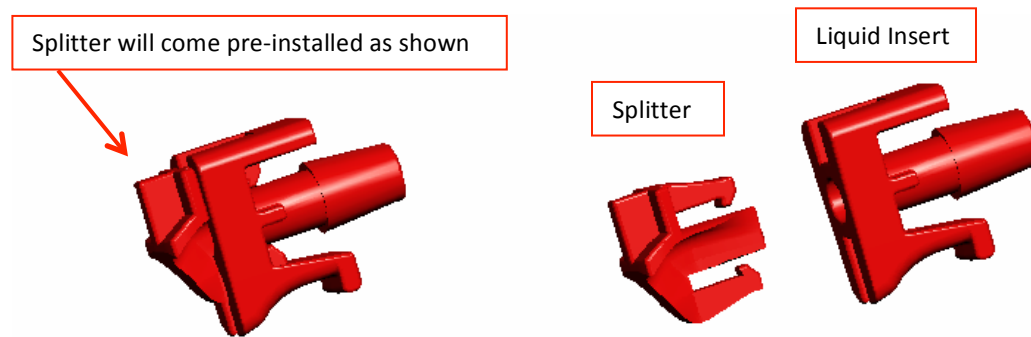

Illustration 1– Liquid Insert

- b) Install the liquid insert assembly into one end of the ¼" tubing. Refer to illustration 2.

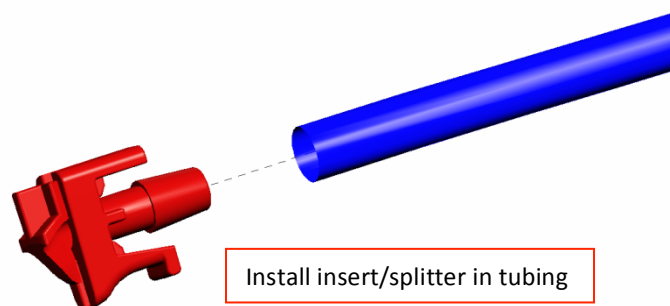

Illustration 2– Insert Assembly Installed in Tubing

Contact SI Distributing with Questions: 800-368-7773

- c) Slide the other end of the tubing through the bottom opening of the tail. Continue feeding the tubing up through the tail, securing it with the two molded hooks. Finish by sliding through the open hole at the top of the tail. Refer to Illustration 3.

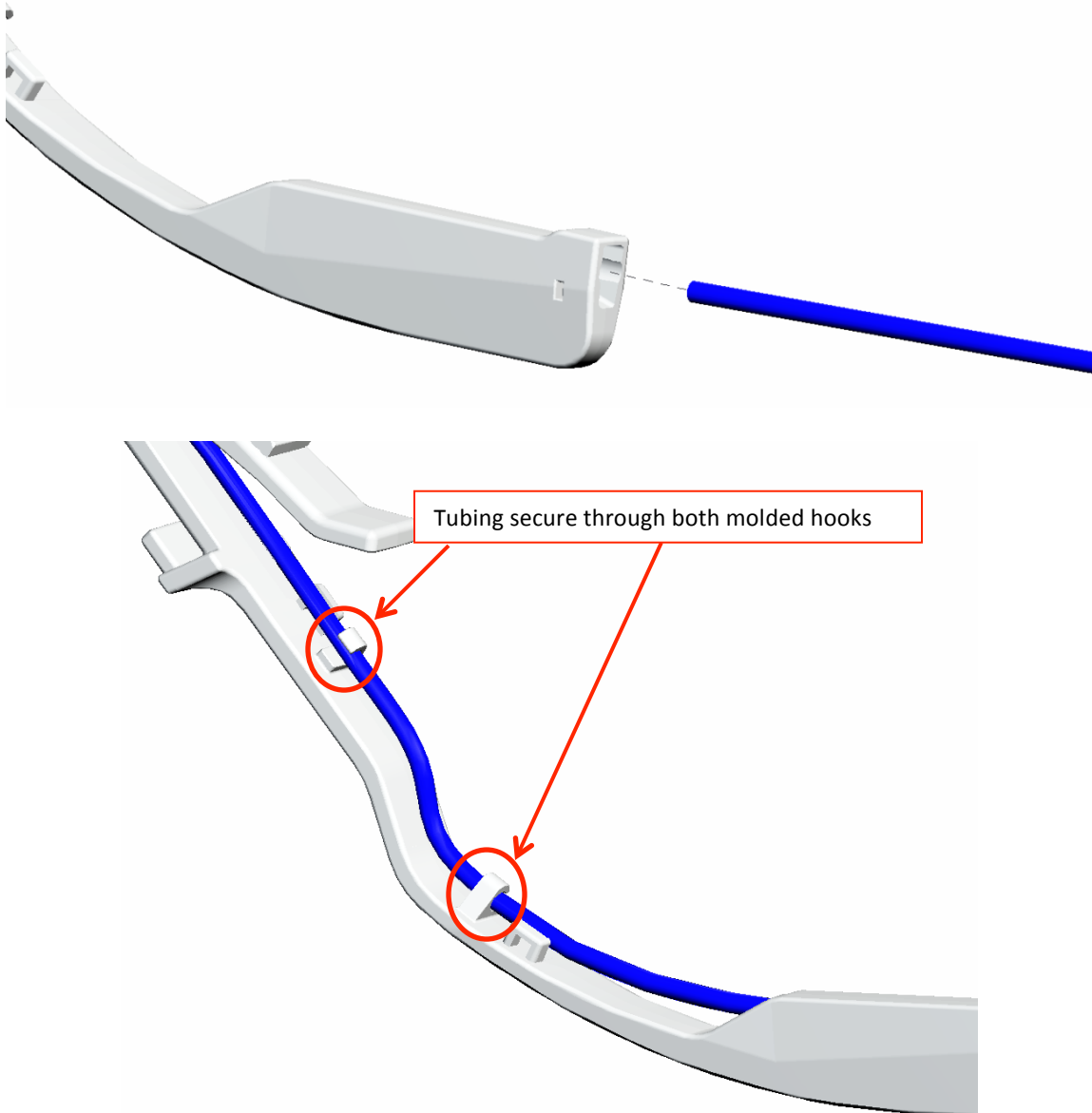

Illustration 3 – Insert Tubing in Firmer

- d) Snap the liquid insert into the open area at the bottom of the tail. Refer to illustration 4. To remove the liquid insert, push a small flat head screw driver (or similar tool) into one of the openings on the side of the tail and pop the insert out.

Note: Do not install the insert into the tail first and then attach the liquid tubing to the insert. There will not be sufficient leverage to install the tubing over the barb on the insert and the tubing will bind.

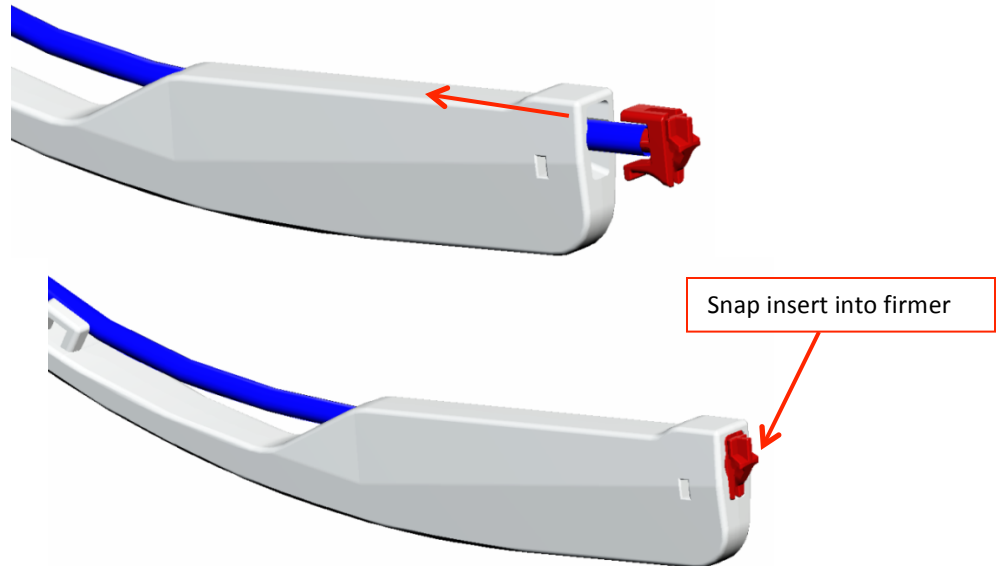

Illustration 4 – Insert installed in firmer

- e) Use the 2" long splice to connect the firmer liquid tubing to the liquid supply line from the manifold.
f) Use the provided zip ties to secure the tubing to the firmer. Refer to illustration 5.

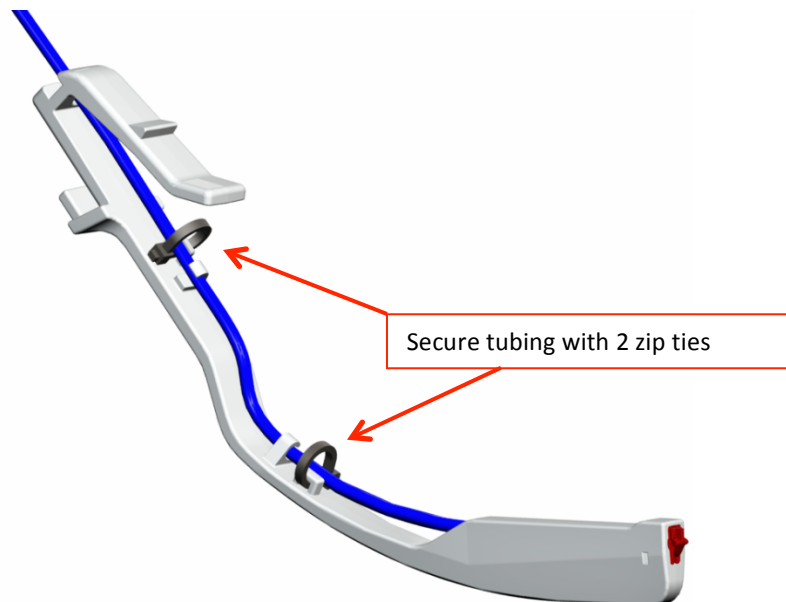

Illustration 5 – Liquid Tubing Secured with Zip Tie

2) Tail Installation and Removal

- a) Insert the tail into the rear opening on the quick attach bracket. A snap should be heard when fully installed. Pull on the tail to make sure it is securely installed. Refer to illustration 6.

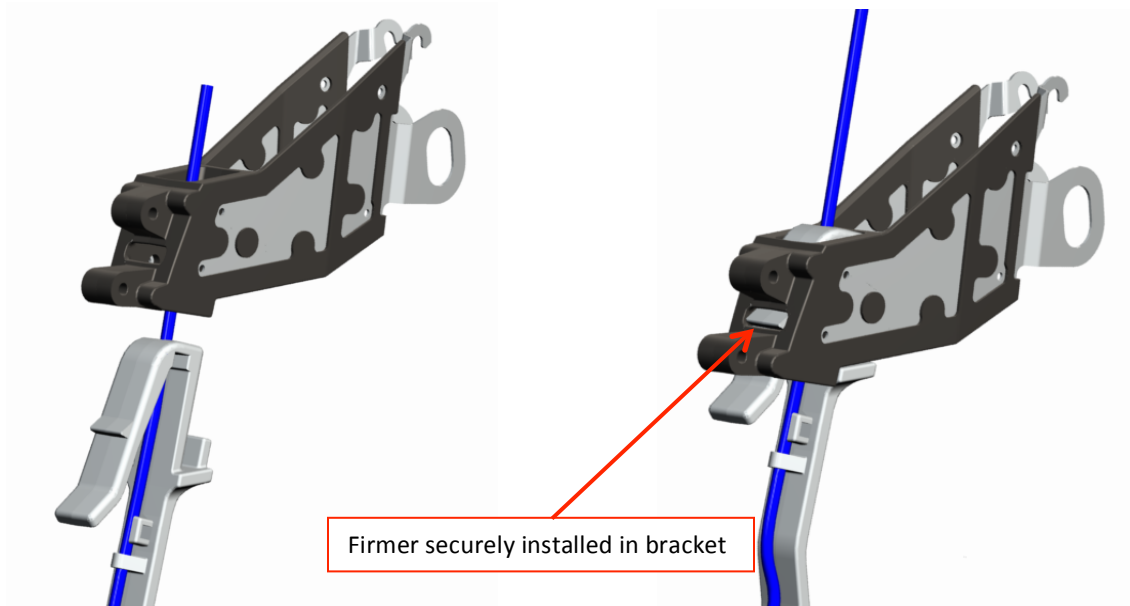

Illustration 6 – Firmer installed in bracket

- b) To remove the tail, simply depress the tab on the tail and pull down and out of the bracket.

As noted above, all quick attach tails have the ability to apply liquid. The new splitter has a larger diameter and can apply much higher rates than the previous splitter model.

- **An in-line orifice must be installed on each row to regulate flow to each row**
- **Orifice sizes should be determined by calibrating the planter and utilizing manufacturer's charts and calculators for target application rate**

Note: Backing up without the planter fully lifted can result in damage to the firmer. To prolong tension, the firmers should be stored not touching the ground between planting seasons.

Contact SI Distributing with Questions: 800-368-7773