

BSCW-899 & 9ZC

FOR CNH 800, 900, 1200 & 2000 SERIES ROW UNITS

INSTALLATION INSTRUCTIONS

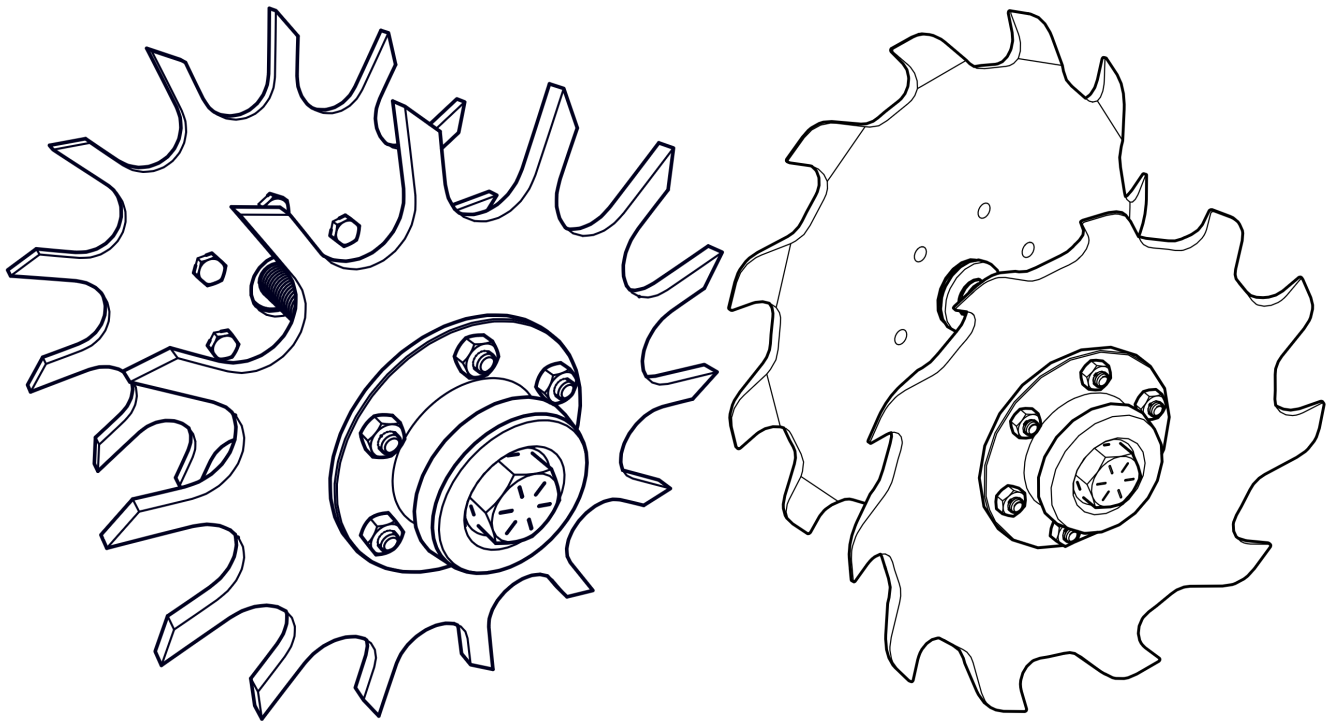

Martin Planter Attachments

Martin Industries LLC

206 Elk Fork Road

Elkton, KY 42220

Telephone: 270-265-5817

E-Mail: martin@martintill.com

www.martintill.com



INSTALLING BSCW899 OR BSCW9ZC WHEELS (800-1200 Series)

- 1) Remove the existing wheels by removing the dust cover and unthreading existing hardware.
 - 2) Remove the bolt and detach the assembly.
 - 3) Pass the provided 5/8-11 X 2 1/2 bolt through the Dust Cover and one thick 5/8" washer as shown below.
 - 4) Pass the bolt through the hub and add one BU10658 (800655) and one SAE 5/8" (788601) washer.
 - 5) Attach the assembly to the planter. Tighten the bolt to 112 ft-lbs. Be sure rotation direction is as shown in the pictures for both wheels. Use the wheel on the opposite side if the rotation direction is opposite.
- Make sure that the beveled side of both wheels are located inside and the Cupped side is facing outward from the Closing arm as shown.

Note: Closing wheel pressure may have to be varied to obtain desired results.

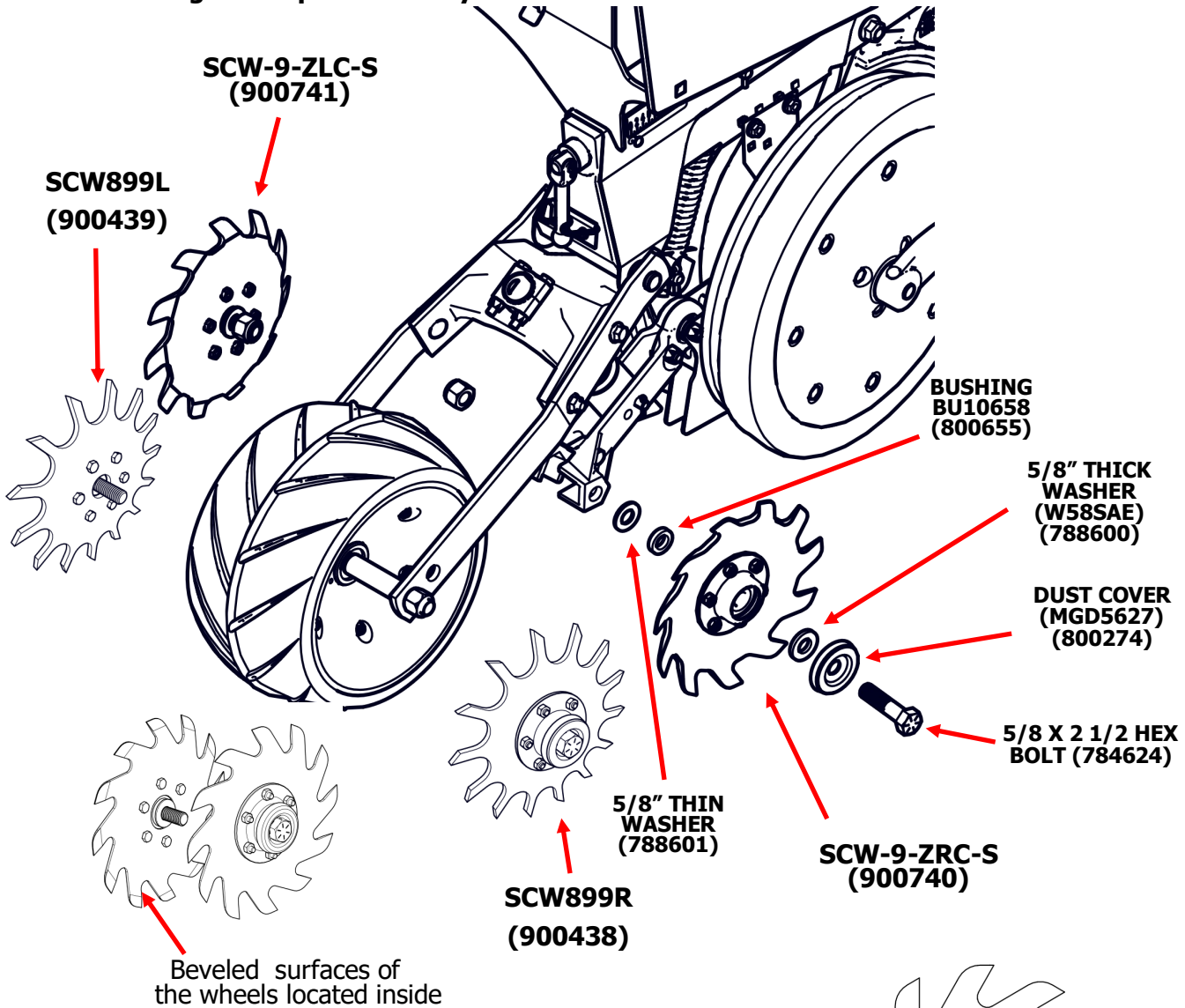

Hardware Provided

1) 5/8 X 2 1/2 Hex Bolt	Qty 2
2) 5/8" Thick Washer(W58SAE-788600)	Qty 2
3) 5/8" Thin Washer (788601)	Qty 2
4) BU10658 (800655)	Qty 2
5) Dust Cover (MGD5627)	Qty 2
6) 5/8" Nyloc Nut (787600)	Qty 2

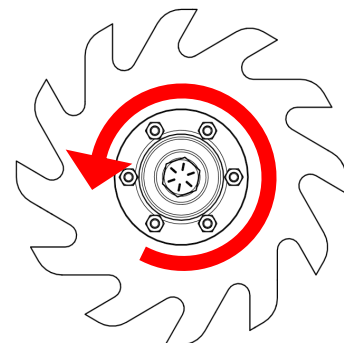

Rotation Direction

INSTALLING BSCW899 OR BSCW9ZC WHEELS (2000 Series)

- 1) Remove the existing wheels by removing the dust cover and unthreading existing hardware.
 - 2) Remove the bolt and detach the assembly.
 - 3) Pass the new provided M16 bolt through the Dust Cover and one thick 5/8" washer as shown below.
 - 4) Pass the bolt through the hub and add one BU10658 (800655) and one SAE 5/8" (788601) washer.
 - 5) Attach the assembly to the planter. Tighten the bolt to 112 ft-lbs. Be sure rotation direction is as shown in the pictures for both wheels. Use the wheel on the opposite side if the rotation direction is opposite.
- Make sure that the beveled side of both wheels are located inside and the Cupped side is facing outward from the Closing arm as shown.

Note: Closing wheel pressure may have to be varied to obtain desired results.

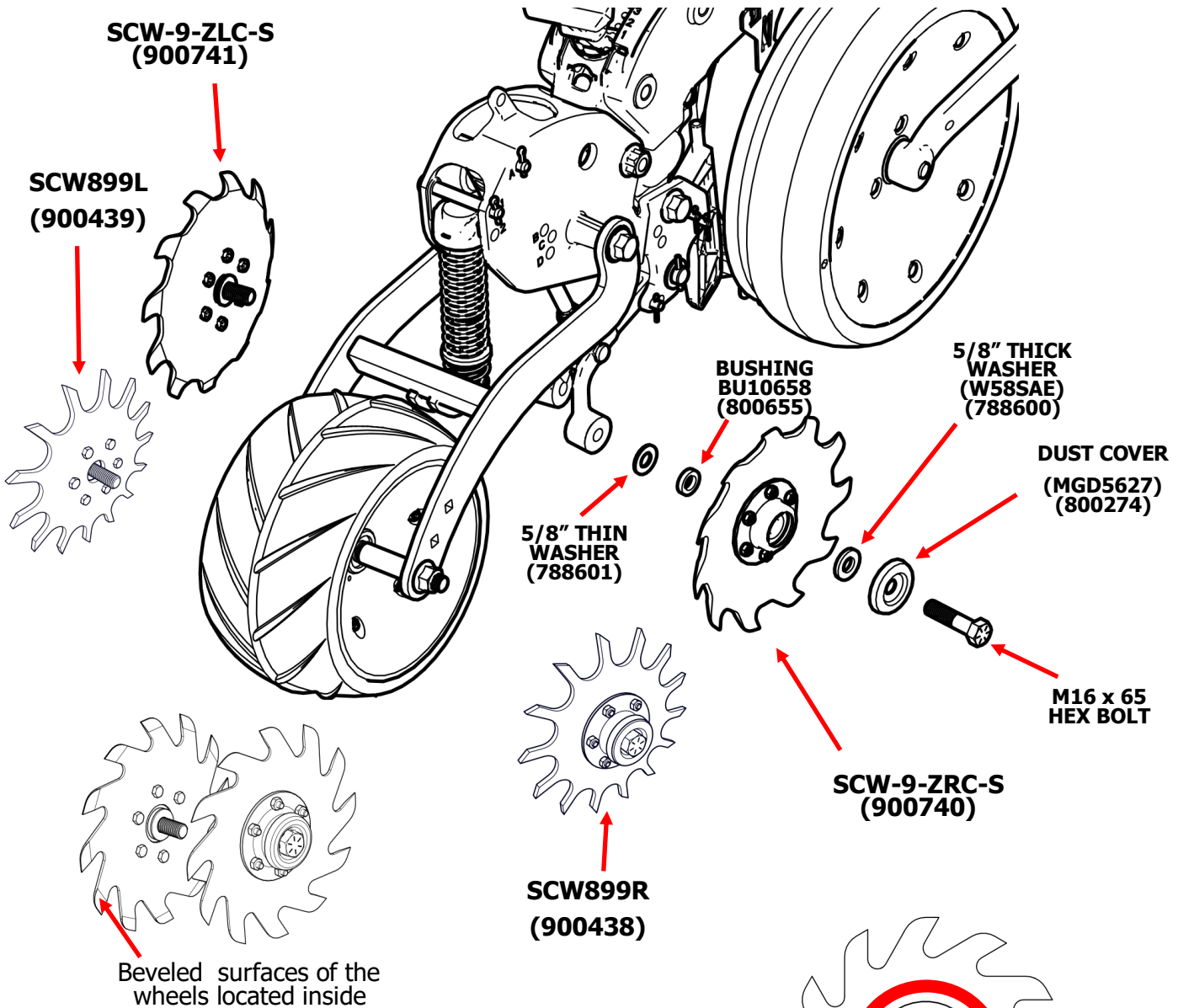

Hardware Provided

1) M16 X 45 Hex Bolt	Qty 2
2) 5/8" Thick Washer(W58SAE-788600)	Qty 2
3) 5/8" Thin Washer (788601)	Qty 2
4) BU10658 (800655)	Qty 2
5) Dust Cover (MGD5627)	Qty 2

INSTALLING BSCW9ZC WHEELS ON CNH 2000 Martin Closing Arm

- 1) If a Martin CNH2000 V-Style closer is installed on planter, follow the below steps to install BSCW9ZC Wheels.
- 2) Remove the bolt and detach current wheel assembly, if wheels already on closing arm.
- 3) Pass the provided 5/8-11 X 2 1/2 bolt, 2 x 5/8x7/8 washers through the Dust Cover and one thick 5/8" washer as shown below. (5/8x7/8 washers should be directly under the head of the bolt)
- 4) Pass the bolt through the hub and add one BU10658 (800655) spacer.
- 5) Attach the assembly to the V-Style Arm. Tighten the bolt to 112 ft-lbs. Be sure rotation direction is as shown in the pictures for both wheels. Use the wheel on the opposite side if the rotation direction is opposite.

Make sure that the beveled side of both wheels are located inside and the Cupped side is facing outward from the Closing arm as shown.

Note: Closing wheel pressure may have to be varied to obtain desired results.

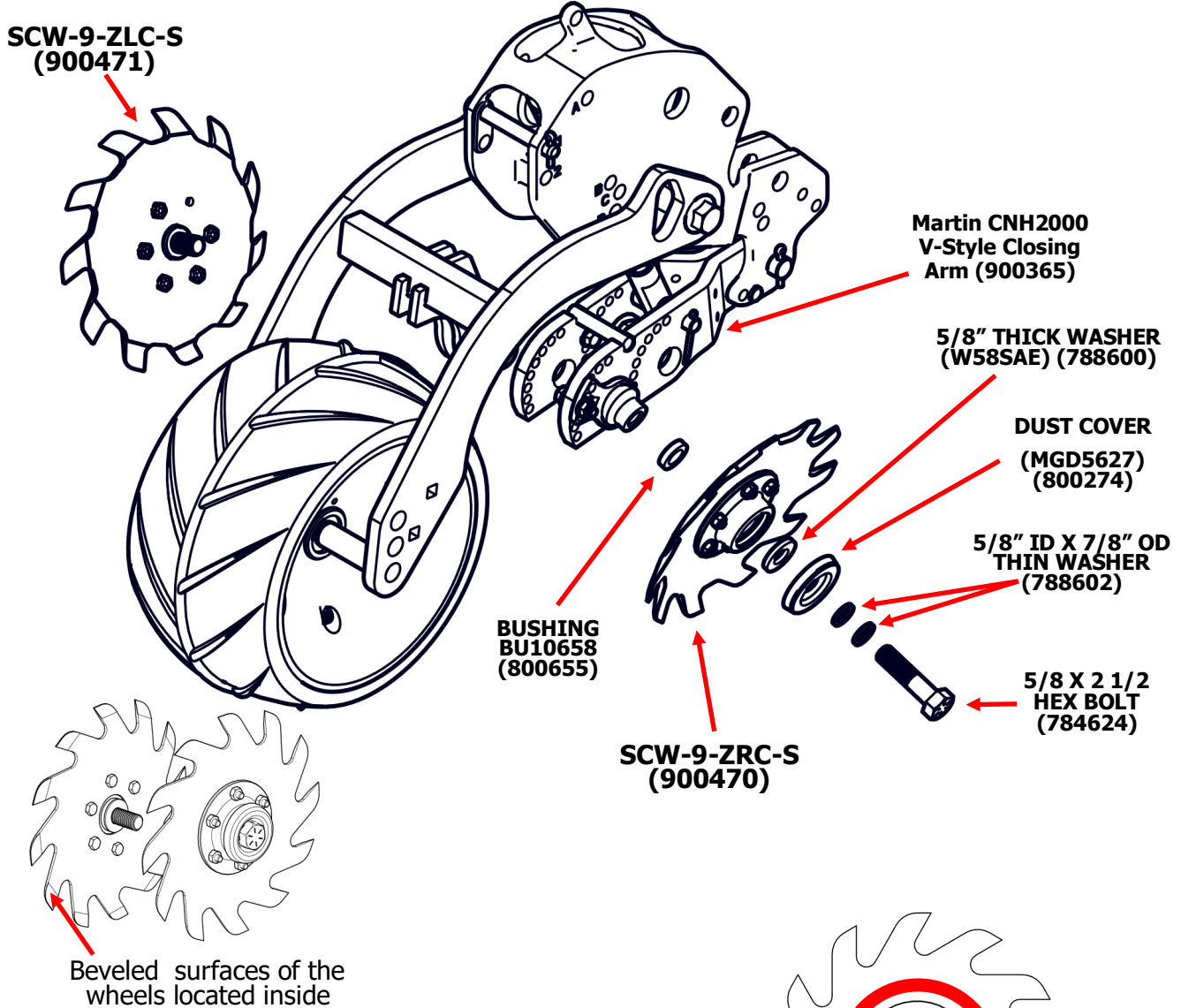

Hardware Provided	
1) 5/8 X 2 1/2 Hex Bolt	Qty 2
2) 5/8" Thick Washer(W58SAE-788600)	Qty 2
3) 5/8" X 7/8" OD Washer (788602)	Qty 4
4) BU10658 (800655)	Qty 2
5) Dust Cover (MGD5627)	Qty 2

